

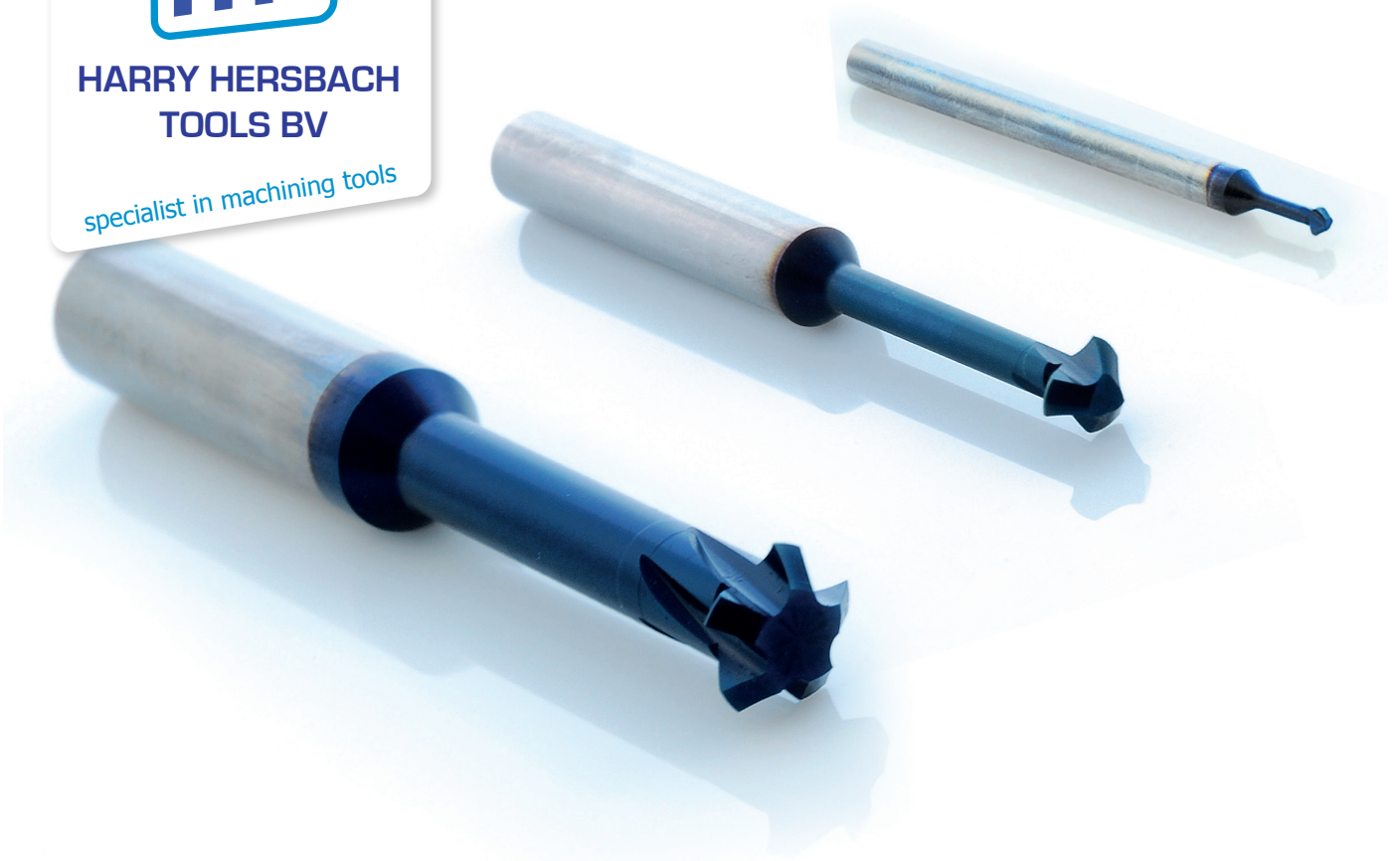

**HARRY HERSBACH  
TOOLS BV**

*specialist in machining tools*



## **Mini Chamfer Mill**

**Solid Carbide Chamfer Mills for chamfering as small as 3 mm**

Special designed solid-carbide mini chamfer mills. Sub Micron grade with Aluminium Titanium Nitride (AlTiN) multi layer coating. Extremely high heat resistant and smooth cutting operation, for high performance, and normal machining conditions. General purpose for all materials.

- Optimal for milling, deburring and back chamfering.
- Double side cutting.
- Spiral flute allows smooth cutting action.

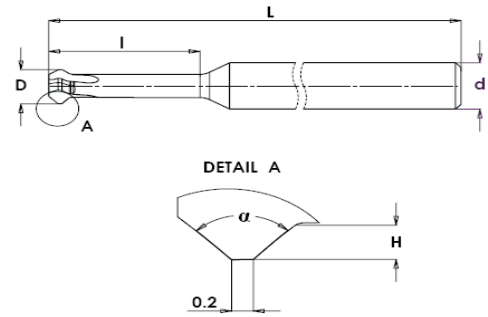
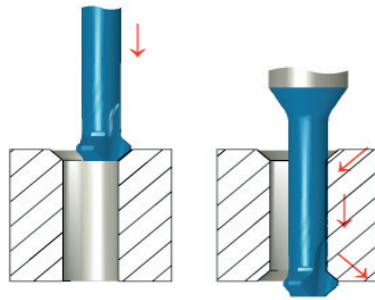

45°	d	D	l	H	Number of flutes	L	Ordering Code	
	mm	mm	mm	mm		mm		
	3	1.5	3.8	0.3	90°	3	39	CMC 03015 C3 A90
	3	2.0	5.0	0.4	90°	3	39	CMC 03020 C5 A90
	3	2.5	6.3	0.5	90°	3	39	CMC 03025 C6 A90
	3	3.0	7.5	0.6	90°	3	39	CMC 03030 C7 A90
	4	3.5	8.8	0.7	90°	3	51	CMC 04035 C9 A90
	4	4.0	10.0	0.8	90°	3	51	CMC 04040 C10 A90
	5	4.5	11.3	1.0	90°	3	51	CMC 05045 C11 A90
	5	5.0	12.5	1.1	90°	3	51	CMC 05050 C12 A90
	6	5.5	13.8	1.2	90°	3	51	CMC 06055 C13 A90
	6	6.0	15.0	1.5	90°	3	51	CMC 06060 C15 A90

Long Reach 45°	d	D	l	H	Number of flutes	L	Ordering Code	
	mm	mm	mm	mm		mm		
	3	3.0	12.0	0.6	90°	3	39	CMC 03030 C12 A90
	4	3.5	14.0	0.7	90°	3	51	CMC 04035 C14 A90
	4	4.0	16.0	0.8	90°	3	51	CMC 04040 C16 A90
	5	4.5	18.0	1.0	90°	3	51	CMC 05045 C18 A90
	5	5.0	20.0	1.1	90°	3	51	CMC 05050 C20 A90
	6	5.5	22.0	1.2	90°	3	58	CMC 06055 C22 A90
	6	6.0	24.0	1.5	90°	3	51	CMC 06060 C24 A90

30°	d	D	l	H	Number of flutes	L	Ordering Code	
	mm	mm	mm	mm		mm		
	3	2.0	5.0	0.4	60°	3	39	CMC 03020 C5 A60
	3	3.0	7.5	0.6	60°	3	39	CMC 03030 C7 A60
	4	3.5	8.8	0.7	60°	3	51	CMC 04035 C9 A60
	4	4.0	10.0	0.8	60°	3	51	CMC 04040 C10 A60
	5	4.5	11.3	1.0	60°	3	51	CMC 05045 C11 A60
	5	5.0	12.5	1.1	60°	3	51	CMC 05050 C12 A60

## Technical Section Cutting Data

Materials	Cutting speed m/min	Feed mm/tooth						
		ø1.5	ø2	ø3	ø4	ø5	ø6	ø7
Low & Medium Carbon Steels	60-120	0.05	0.05	0.07	0.09	0.11	0.13	0.14
High Carbon Steels	60-90	0.04	0.05	0.06	0.08	0.09	0.10	0.12
Alloy Steels	50-80	0.04	0.04	0.05	0.05	0.06	0.07	0.07
Cast Steels	60-90	0.03	0.03	0.04	0.05	0.06	0.06	0.07
Stainless Steels	70-90	0.04	0.04	0.05	0.05	0.06	0.07	0.07
Cast Iron	40-80	0.05	0.05	0.07	0.09	0.11	0.13	0.14
Aluminium	80-150	0.05	0.05	0.07	0.09	0.11	0.13	0.14
Nickel Alloys, Titanium Alloys	20-40	0.03	0.03	0.04	0.04	0.05	0.06	0.06
Synthetics, Duroplastics, Thermoplastics	50-200	0.10	0.11	0.12	0.14	0.16	0.18	0.20